

BONNERWORTH PARK REDEVELOPMENT

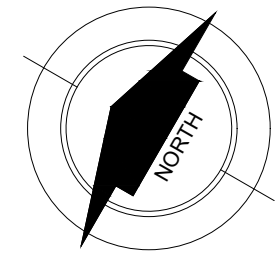

1:600m

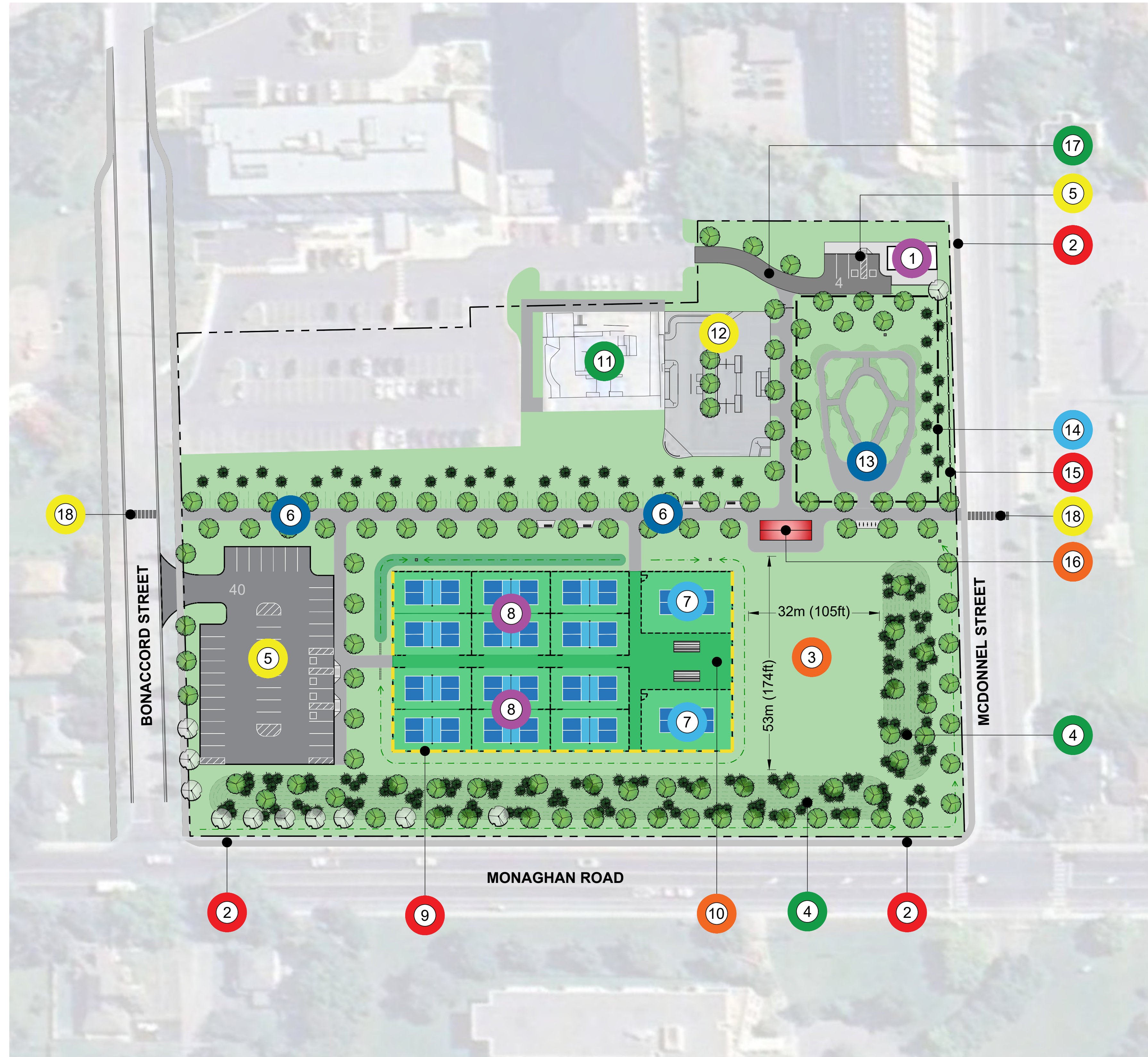

KEYS

- | | | | |
|---|---|----|--|
| 1 | EXISTING WASHROOM BUILDING | 10 | PROPOSED OPEN PLAZA (+/-315m ²) |
| 2 | EXISTING MUNICIPAL SIDEWALK | 11 | EXISTING SKATEPARK |
| 3 | PROPOSED OPEN LAWN AREA | 12 | PROPOSED SKATEPARK EXPANSION |
| 4 | PROPOSED LANDSCAPED BERMS | 13 | PROPOSED PUMP TRACK |
| 5 | PROPOSED VEHICLE PARKING TOTAL PARKING STALLS: 44 | 14 | LIMIT OF SLOPE TRANSITIONS REQUIRED FOR PUMPTRACK |
| 6 | PROPOSED WALKWAY CONNECTIONS | 15 | PROPOSED DECORATIVE METAL FENCE |
| 7 | PROPOSED ACCESSIBLE PLAY PICKLEBALL COURTS (2) | 16 | PROPOSED SHADE SHELTER WITH GATHERING TABLES |
| 8 | PROPOSED STANDARD PLAY PICKLEBALL COURTS (12) | 17 | PROPOSED MAINTENANCE AND VEHICLE ACCESS ROUTE |
| 9 | PROPOSED ACOUSTIC SCREEN / NOISE BARRIER | 18 | PROPOSED CROSSWALK CONNECTIONS (REFER TO NOTE BELOW) |

LEGEND

- | | | | |
|--|---|--|----------------------------------|
| | EXISTING TREES | | ENHANCED VEGETATED SWALE |
| | PROPOSED DECIDUOUS TREES | | SOD |
| | PROPOSED CONIFEROUS TREES | | ASPHALT PAVING (WALKWAYS) |
| | PROPOSED BIKE RINGS ON CONCRETE BASE | | ASPHALT PAVING (PARKING LOT) |
| | PROPOSED BENCH ON CONCRETE BASE | | CONCRETE PAVING |
| | PROPOSED LOCATION FOR SPECTATOR BLEACHERS | | SWALES |
| | | | BLACK VINYL CHAIN LINK FENCE |
| | | | ACOUSTIC SCREENS / NOISE BARRIER |

NOTE:

BONACCORD STREET ROAD RECONSTRUCTION INCLUDING SIDEWALKS, CURBS, AND PEDESTRIAN CROSSING, IF WARRANTED, IS NOT INCLUDED IN THE BONNERWORTH PARK DEVELOPMENT PROJECT. BONACCORD STREET RECONSTRUCTION WORKS ILLUSTRATED ON THIS PLAN ARE CONCEPTUAL ONLY, AND IS SUBJECT TO FUTURE BUDGET APPROVALS AND PUBLIC CONSULTATION.